



12段阻尼可調

## Magic TOP

### 產品使用說明書 Installation Manual

承蒙您使用本公司產品，您的滿意與支持是我們前進的動力，歡迎有任何意見指教，可透過下列各網站與我們聯繫，SAJIN 由衷向您致謝！

Thank you for using our products, your satisfaction and support makes us more motivated to move forward.

You can contact us through the following websites with your suggestions and comments .  
Thank you very much.

## Magic TOP

Patent NO.108207822/M389046

Original Damping Adjustable Shock Absorber

原廠型阻尼可調避震器 獨家專利NO.108207822/M389046

E-mail:011sajin@gmail.com

IG:sajinsuspension

TEL:0968507717

- ◎ 感謝您購買本商品。
- ◎ 安裝前，請詳此說明書。
- ◎ 本產品享有18個月，購買時請向經銷商蓋取店章。
- ◎ 安裝前請確認車種、年份是否相符，若發現規格不符時，請立即與購買處或經銷商辦理換貨。
- ◎ 開箱後，若發現缺件或損壞之情況，請與購買處或經銷商辦理換貨。
- ◎ Thank you for the purchase of SAJIN International's shock absorbers.
- ◎ Please read this manual carefully before the installation of this product procured.
- ◎ The product is under 18 months limited warranty from the day of purchase , under normal and reasonable utilizations, please remember to ask the agent for the issue of warranty card and the proof of purchase/receipt.
- ◎ Please check the application and serial no. carefully, before the start of installation onto your automobile. SAJIN International did not bear the responsibility caused by the wrong fitting of a product to the vehicle.
- ◎ Under the circumstance of any shortage in the accessory kits or any improper specifications of parts, please contact the original agent directly with valid proof of purchase.



## 一、產品說明

- Magic TOP以原尺寸避震器阻尼進化設計製造，以改良升級來提昇使用性。
- SAJIN不承擔任何關聯非直接由本產品所產生的意外、傷害、危險、死亡。
- 本避震器阻尼或彈簧係數與原廠標準不同。
- 裝置本避震器於道路行使，請遵循當地法令來使用。
- 在任何情況下，如無SAJIN同意，請不要自行分解油壓筒身，如自行拆解而導致危險或產品損壞，SAJIN將不負責任。
- 本產品內含高壓氮氣，不可靠近火源或暴露在火源之下，此可能造成損壞產品或是發生爆炸的危險。
- 本司不承擔因各國違反之法令與法規等法律事件。

## 二、外觀名稱

- ① 阻尼調整鈕
- ② 活塞桿
- ③ 防塵套
- ④ 彈簧座
- ⑤ 剎車油管托架
- ⑥ 支架/車軸板
- ⑦ 平衡桿球頭固定架

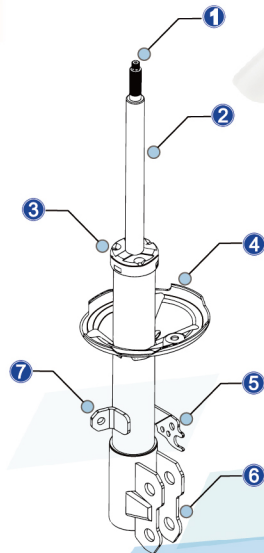

## I .About the product

- Magic TOP performance shock absorber is designed, manufactured, and originated from the OEM specifications for improve upgrades and improve usability.
- SAJIN International did not bear the responsibility caused by the wrong fitting of a product to the vehicle.
- The damper ratio might not be the same with the OEM suspension system.
- To drive with this type of shock absorbers on the streets or public roads may not be legit and may be in conflicted with the local law instated.
- Without the consent and consultancy of SAJIN International, please do not attempt to dissect the hydraulic cylinder and avoid the hazardous risks of explosions and damages. SAJIN International will not be held responsible for the mentioned risks or any indemnities with the improper installation and abnormal usage.
- With pressurized nitrogen packed inside the product, please keep it away from intensive heat or fire to avoid the hazardous risks of heavily explosion from seriously damage.
- SAJIN International will not bear any responsibility of legal events such as laws and regulations that are violated by various countries.

## II.Exterior

- ① Damping-Tuning Knob
- ② Piston
- ③ Dust cover
- ④ Coil spring seat
- ⑤ Brake-tube bracket
- ⑥ Strut
- ⑦ Tie rod bracket

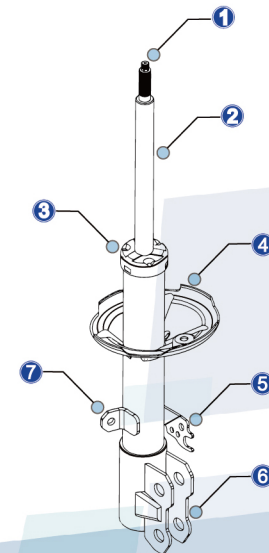

### 三、安裝前

- 安裝前請詳閱本手冊內容。
- 請先行確認產品是否與安裝車種相符。
- 安裝前須檢視產品外部零件是否完整，如有損壞或缺件，請立即通知代理商。
- 說明書該版權為本公司所有，禁止部份或全部翻印或複製。
- 安裝本產品須由專業人員（專業執照）進行安裝作業。
- 本產品非通用部品，唯該車型所適用，勿於其他車型裝配。
- 若擅自修改本產品，若因不正確裝配或修改，致產生任何意外，本司則不以承擔。
- 安裝時請勿撞擊活塞桿，若造成損傷而產生漏油，本司將不以負責。

### 四、安裝時

- 安裝時活塞桿部位，請勿使用鐵製夾具與鎖具固定，以免產生損壞。
- 安裝時需以搭配以原車之避震器總成，套裝於本產品上。
- 本產品可搭配降低彈簧使用。
- 請確保安裝煞車油管或ABS線確實固定於原設定位置，以避免油管斷裂影響安全。
- 上座與避震器和螺帽裝配時，請以手動扳手鎖入，切勿使用氣動扳手，避免扭力過大造成活塞桿螺牙斷裂。若斷裂，本司不予以保固與負責。

### III、About the Manual

- Please read these contents of manual in details.
- Please check the application and serial no. carefully, before the start of installation onto your automobile.
- Under the circumstance of any shortage in the accessory kits or any improper specifications of parts, please contact the original agent directly with valid proof of purchase.
- This documentation is owned by SAJIN and strictly prohibited by law to be further duplicated or copied and distributed.
- The product has to be installed or removed by professional technicians or certificated personnel.
- This product is not a general-purpose part, but it is only applicable to this model, and it is not to be assembled in other models.
- If you modify this product without authorization, SAJIN will not be liable for any accidents caused by improper assembly or modification.
- SAJIN is not responsible for impact damage to the piston rod and resulting of oil leakage during installation.

### IV、About the Installation

- Do not use iron clamps and vise during the installation of the piston rod to avoid damage.
- It must be installed on the product with the shock absorber original assembly parts.
- This product can be used with lower springs.
- Please ensure that the brake hose or ABS cable is fixed in the original position to avoid the tubing breakage.
- When assembling the upper mount and the shock absorber with nut, please lock it with a manual wrench. Do not use a pneumatic wrench to avoid the pistonrod being broken due to excessive torque. SAJIN International is not responsible for the warranty for this issue.

## 五、安裝後

- 安裝後欲行駛測試前，請再確認各零件是否皆以緊配與鎖緊。若未鎖緊，易產生異音或行駛的危險。
- 請依阻尼之調整，可先以第6段（中段）測試體驗，再依個人需求來調整最符合自身之阻尼需求。
- 定期檢查各固定螺絲及螺帽的緊配度。
- 防塵套若有壞損，易使沙石污垢等噴入活塞桿導致活塞桿之壽命降低，請定期檢視。

## 六、阻尼調整方式

- 左旋—逆時鐘調整，到底為第01段（全開）。
- 右旋—順時鐘調整，到底為第12段（全閉）。
- 依個人需求調整所需的阻尼軟硬；調整阻尼時，左右邊避震器之阻尼段數須相同。



## V. After installation

- After installing the shock absorber, please confirm that each part is tightly fitted and locked before driving test. If it is not locked, it is easy to produce abnormal sound or danger of driving.
- According to the adjustment of the damping, you could turn with the 6 th level (middle-level) for testing, and adjust to the requirements for your needs.
- Please regularly to check the tightness of each fixing screw and nut.
- Please be sure to check regularly if the dust cover is worn, it is easy to cause sand and gravel dirt to spray into the piston rod, which will reduce the life time of the piston rod.

## VI. Adjustable Damper/12 levels

- Turn it counter-clockwise, the damper will become softer and end in 1st level.
- Turn it clockwise, the damper will become harder and end in 12th level.
- It should be noted that while making the modification of a damper, please make sure the damper of right side and left side for the front or rear pair is set at the same level simultaneously.



## 七、問題檢測

## 【漏油檢測】

須依專業人員判定，避震器外表油漬是否為漏油狀況。

1. 必須先將防塵套取出。
2. 將活塞桿、油封位置擦拭乾淨。
3. 將活塞桿向下做壓測試動作。
4. 於檢視點（如圖7-1）觀察是否有大量油漬溢出之狀況。
5. 若下壓後無法上升，即為氮氣已外漏，亦為NG現象。

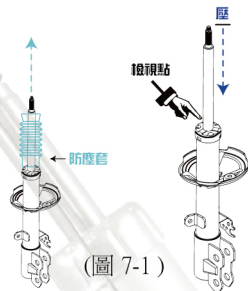

(圖 7-1)

## 【異音檢測】

需依專業人員判定，異音狀況亦有可能因其它底盤零件所引起之異音。

1. 請確認支架螺絲、上座螺帽和避震器與車體相關之配件是否皆已鎖緊。
2. 檢查避震器是否作動正常。
3. 檢視異音是否由筒身所發出。

## 【阻尼檢測】

1. 調整阻尼時，轉動旋鈕時，若無法轉停止，請先將檢查旋鈕之定位螺絲是否有鎖住活塞桿之調整鈕（如圖7-2）。
2. 調整阻尼時，調整鈕若無法轉動，則可能調整鈕內之零件卡緊，此時請以較大力道轉開即可。
3. 將避震器下壓時若全開與全閉之回昇速度皆相同，則可能為調整失常。

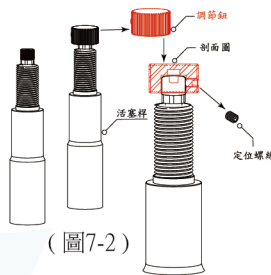

(圖 7-2)

## VII、Problem detection

## 【Oil leaking detection】

It must need determined by professional technicians if is a leaking condition external of the shock absorber.

1. The dust cover must be removed first.
2. Wipe the part of piston rod and oil seal clean.
3. Test the piston rod under pressure.
4. Observe at the inspection point (Figure 7-1) whether there is a large amount of oil leaking.
5. If piston rod can't rise after pressing as nitrogen leaking, it would be NG phenomenon.

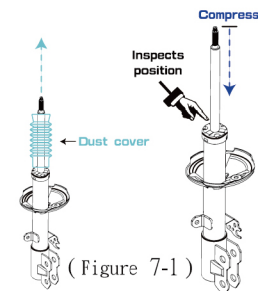

(Figure 7-1)

## 【Abnormal sound detection】

It must be determined that if the abnormal sound condition caused by other chassis parts.

1. Make sure to lock the strut screw and upper mount nuts, and other related accessories of shock absorber.
2. Check that the shock absorber is operating normally.
3. Check if the abnormal sound is emitted from the inner shock.

## 【Damping detection】

1. If you can't turn to stop the rotary button when adjusting damping of shock absorber, please check the setting screw of knob to lock the adjustment knob of the piston rod (Figure 7-2).
2. If the rotary button can't be rotated when adjusting the damping, this situation may be the clamping condition of the adjustment button. In this case, please turn it with a larger force.
3. If the rebound speed of the 1st level same as 32th level when the shock absorber is pressed down, it may be an adjustment failure.

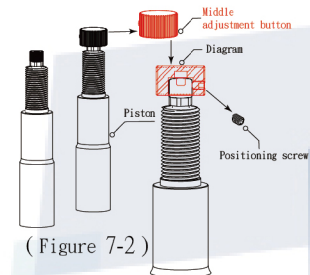

(Figure 7-2)

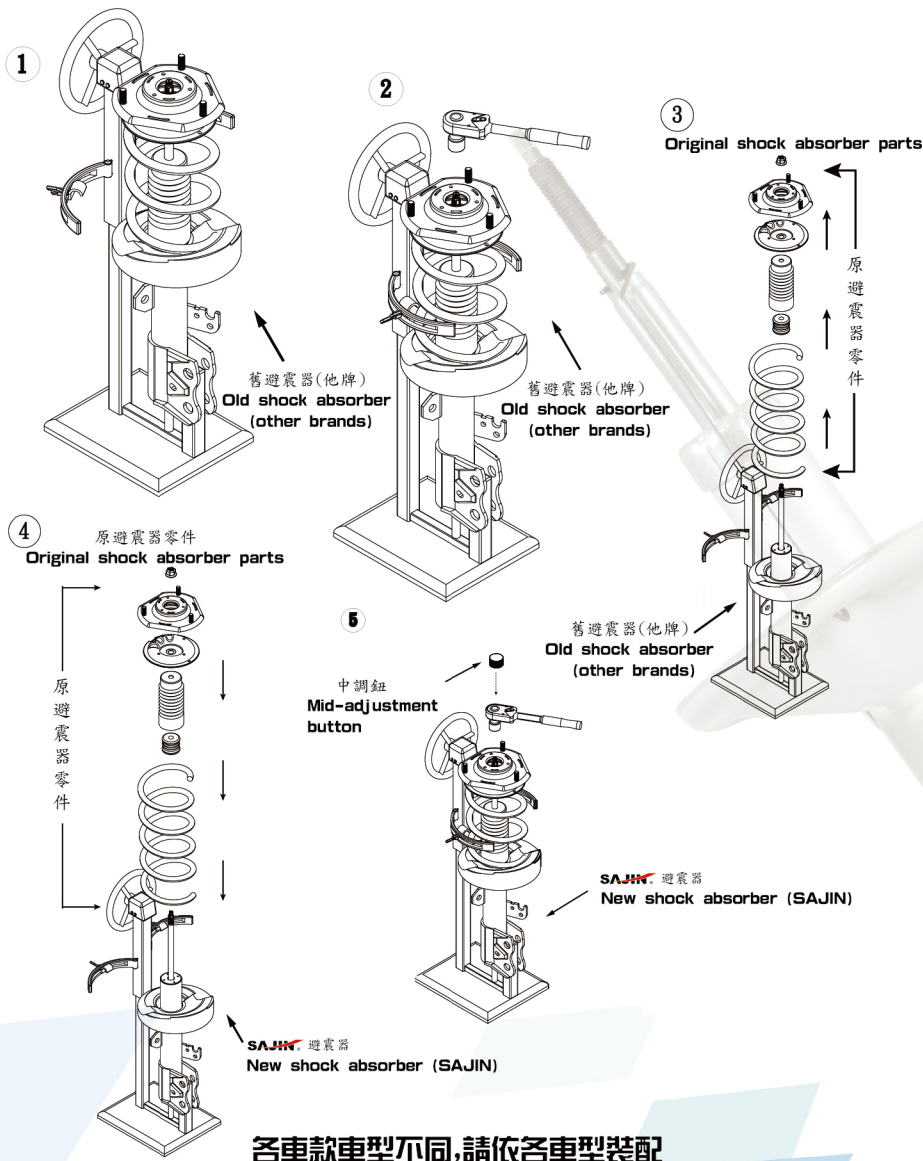

各車款車型不同,請依各車型裝配  
Please assemble according to each car model, this product is only applicable to this model.

## 安裝圖示/Installation diagram

### 總成完成品/Assembly

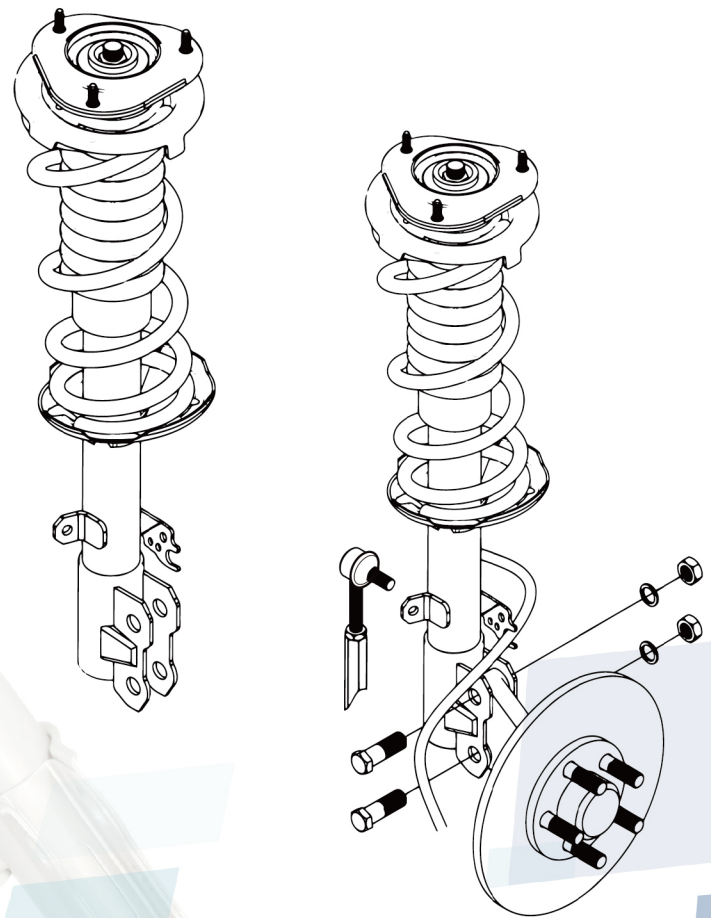

各車款車型不同,請依各車型裝配  
Please assemble according to each car model, this product is only applicable to this model.